

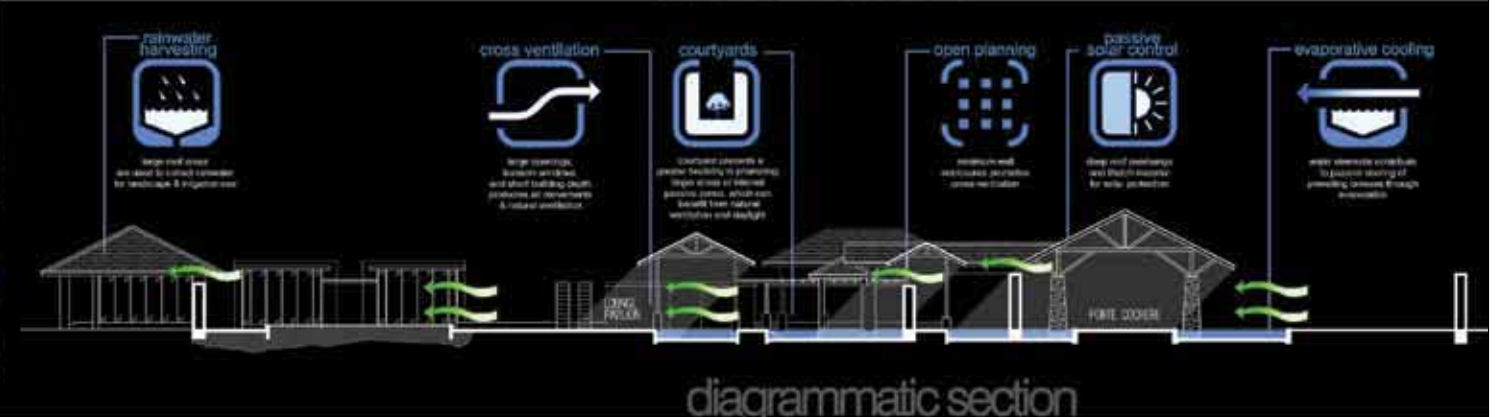

Green Design Award
WINNER

SA ARCHITECTS SDN BHD
MALAYSIA
Tambun International Hotspring & Jungle Resort

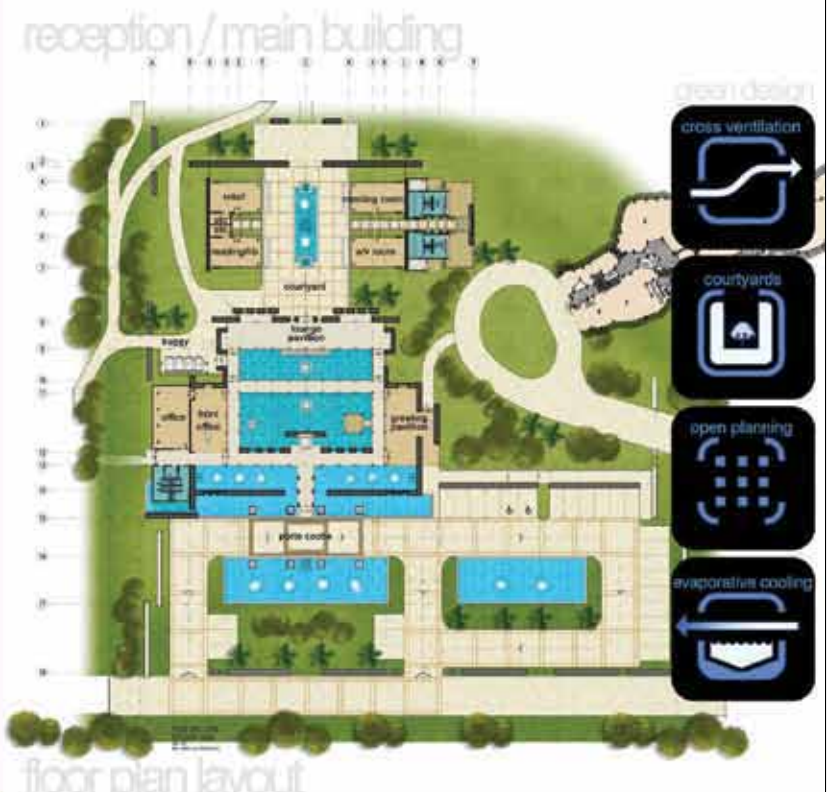



WINNER

SA ARCHITECTS SDN BHD

MALAYSIA

Tambun International Hotspring & Jungle Resort

water reticulation



The development consists of the existing primary water supply throughout the site for various uses including for domestic, industrial, office and landscape and water features. Due to the high temperature, the hot water originating from the absorption is fed through a pump which distributes the water throughout the entire site. The distance involved by the water through the pipes will allow it to dissipate naturally without any active cooling systems.



spa village

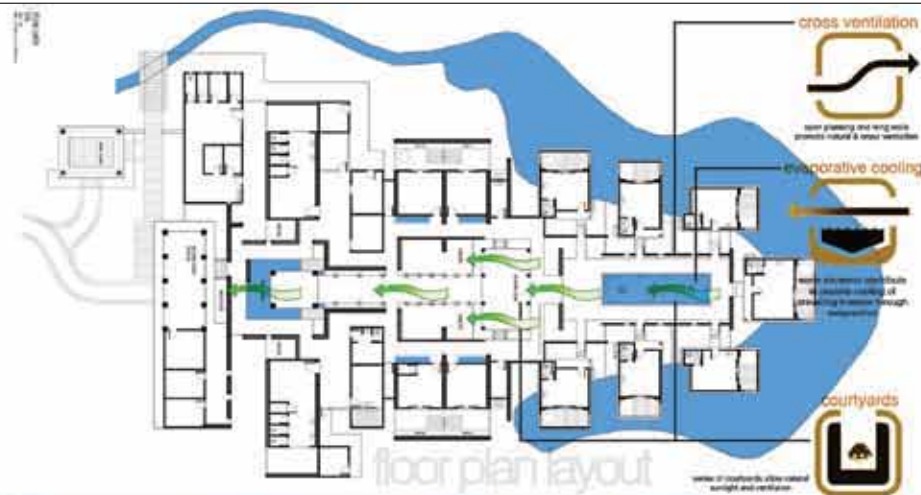

- cross ventilation**
open planning and long walls promote natural & cross ventilation
- evaporative cooling**
water features contribute to passive cooling of building through transpiration
- courtyards**
water in courtyards also natural sunlight and ventilation

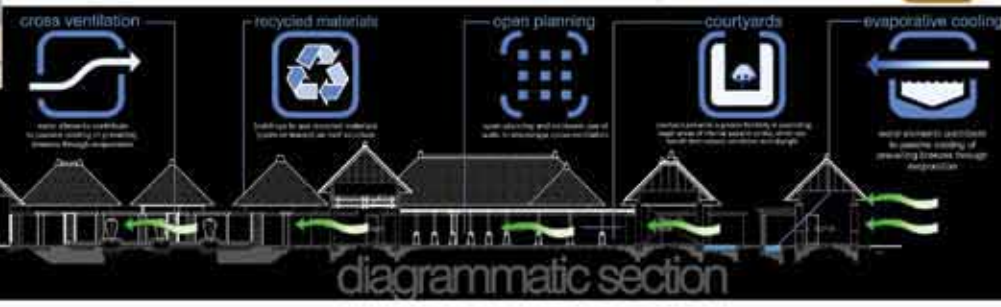

- cross ventilation**
water features contribute to passive cooling of building through transpiration
- recycled materials**
timber used for spa structure material is sourced as local material
- open planning**
open planning and long walls promote natural & cross ventilation
- courtyards**
water in courtyards also natural sunlight and ventilation
- evaporative cooling**
water features contribute to passive cooling of building through transpiration

steam cave: environmental features



Three decks and four steam bathing basins provide spa guests to proceed to purchase through the brick decks and an artificial cave structure built to trap the steam.

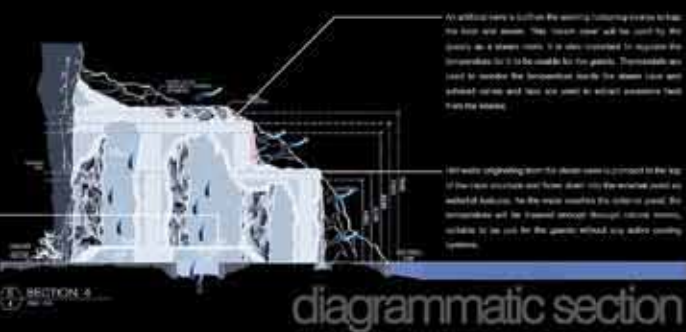

An artificial cave is built on the existing volcanic crater to trap the hot steam. This steam cave will be used by the guests as a steam room. It is also important to regulate the temperature so it is suitable for the guests. Therefore, an open air structure is used to regulate the temperature inside the steam cave and natural steam and heat are used to extract moisture from the steam.



floor plan layout

diagrammatic section



tambun international hotspring & jungle resort, ipoh malaysia



BCI ASIA TOP TEN GREEN AWARD 2009